

# Low Pass Filters

## Series 280

### Features

- **40 dB Stop Band Rejection**
- **Models Available from 2.6 to 90 GHz**
- **High Frequency Models Available on Request**



Model 19280

Low pass filters simplify measurements in microwave systems and enhance system performance by effectively reducing undesirable signals, ie harmonics, to an acceptably low level.

All models provide a very wide 'stop band' of frequencies above the recommended waveguide band. The pass band VSWR is generally better than 1.5:1 and insertion loss less than 1.5 dB.

Filters of this type are particularly suitable for applications involving swept or slotted line measurements.

A range of standard models is available as detailed below. Customised and special models can be combined with other devices. For example a low pass filter combined with waveguide to coax adaptor can also be supplied.

### ORDERING INFORMATION

Model: Description

Example: Model 22280 Low pass filter

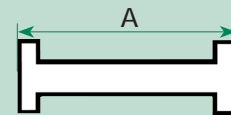

Model	Waveguide			Passband Frequency Range (GHz)	Stop Band Frequency Range (GHz)	Stop Band Rejection (dB)	Maximum Insertion Loss (dB)	VSWR Generally better than	Dimension A (mm)	Model
	WG	R	WR							
10280	10	32	284	2.60 - 3.95	5.20 - 11.85	>40	1.5	1.5	500	10280
11A280	11A	40	229	3.30 - 4.90	6.60 - 14.70	>40	1.5	1.5	450	11A280
12280	12	48	187	3.94 - 5.99	7.88 - 17.97	>40	1.5	1.5	375	12280
14280	14	70	137	5.38 - 8.18	10.76 - 24.54	>40	1.5	1.5	250	14280
15280	15	84	112	6.58 - 10.0	13.16 - 30.00	>40	1.5	1.5	200	15280
16280	16	100	90	8.20 - 12.5	16.40 - 37.50	>40	1.5	1.5	160	16280
17280	17	120	75	9.84 - 15.0	19.68 - 45.00	>40	1.5	1.5	140	17280
18280	18	140	62	11.9 - 18.0	23.80 - 54.00	>40	1.5	1.5	110	18280
19280	19	180	51	14.5 - 22.0	29.00 - 66.00	>40	1.5	1.5	100	19280
20280	20	220	42	17.6 - 26.7	35.20 - 80.10	>40	1.5	1.5	80	20280
22280	22	320	28	26.4 - 40.1	52.80 - 120.3	>40	1.5	1.5	60	22280
23280	23	400	22	33.0 - 50.1	66.00 - 152.1	>38	1.5	1.8	50	23280
24280	24	500	19	39.3 - 59.7	78.60 - 179.1	>38	1.8	1.8	50	24280

Models are available at higher frequency bands. Details upon request.

Series 280

For standard flange types and recommendations see pages 108 onwards